

StaticCatch™ Media (Resin) Traps

Client Data

Name: Project Name:
 Company:
 Address:
 City: Province: Post Code:
 Phone: Fax:
 Email:

Application Data

SPOOL PIECE INLINE

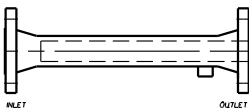

SPLIT-BODY FULL-BORE INLINE

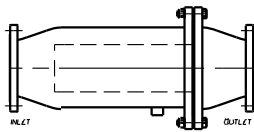

T-BODY FULL-BORE INLINE

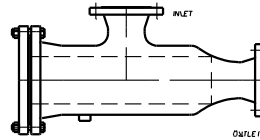

Y-BODY FULL-BORE INLINE

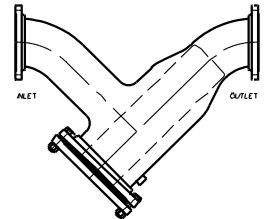

StaticCatch Model: Spool-Piece Inline T-Body Full-Bore
 Split-Body Full-Bore Inline Y-Body Full-Bore Inline

Screen slot size (1/2 media size suggested): mm decimal inches

Screen open area (times line ID cross-sectional area): 1.5x 2x 3x

Screen material: 304ss 316ss C-276

Body material: 304ss 316ss C-276 Carbon Steel (epoxy-lined) Y N

Design maximum pressure: psi kPa

Design maximum temperature: Fahrenheit Celsius

ANSI flange connection (line) size: Class: 150 300 600

Quantity required: Options: Sight glass Valve for drain (plug standard)

Comments: